

FASCO MOTORS MAY PROVIDE TECHNICAL ASSISTANCE TO OUR CUSTOMERS IN MANY AREAS. HOWEVER, SINCE FASCO MOTOR IS NOT AWARE OF ALL DATA CONCERNING THE USE AND APPLICATION OF THIS MOTOR, THE FITNESS OF THE MOTOR FOR THE APPLICATION MUST BE DETERMINED BY AND IS THE RESPONSIBILITY OF THE CUSTOMER.

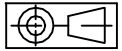

MOTOR SPECIFICATION

80855BQVA-A17S

Q.R. No.	-	CUSTOMER NO.	6011637S		
CUSTOMER	SOUTHCORP				
MOTOR RATING	VOLTS	240	Hz	50	Ph 1 Duty S1 A.O.M.
	RPM.	1350		4.9 AMPS	
NOM. OUTPUT	750 WATTS				
ROTATION	CLOCK WISE AT DRIVE END				
CAPACITOR	START	-----	μF/V	RUN	20/440 μF/V
ENCLOSURE	VENTED				
MOTOR TYPE	PSC	INSULATION CLASS	F155		
THERMAL PROTECTION	AUTO RESET OVERLOAD				
APPLICATION	EVAPORATIVE COOLER				
BEARING D.E.	6202 DDU C3	LUBRICATION	LONG LIFE, WIDE RANGE		
BEARING N.D.E.	6202 DDU C3				
SUPPLY LEAD	-				
EARTH PROVISION	VIA TERMINAL BLOCK				
BASIC BUILD SPECIFICATION	305-629-01	PAINT/ COLOUR	PC GREY CASE PLAIN E/SHIELDS		
PERFORMANCE SPECIFICATION	SP85178-02				
CONNECTION DIAGRAM	393-402-05	RATING LABEL	SSTDAUTO.FMT		

FINAL INSPECTED MOTORS MUST COMPLY WITH H ELECTRIC MOTOR VIBRATION SPECIFICATION (ES049)

THIRD ANGLE PROJECTION

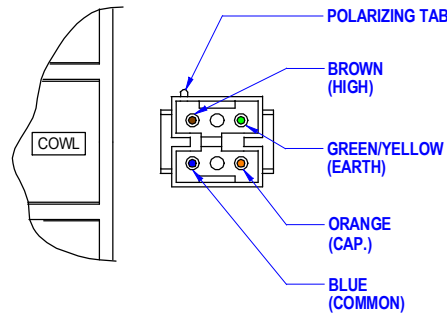
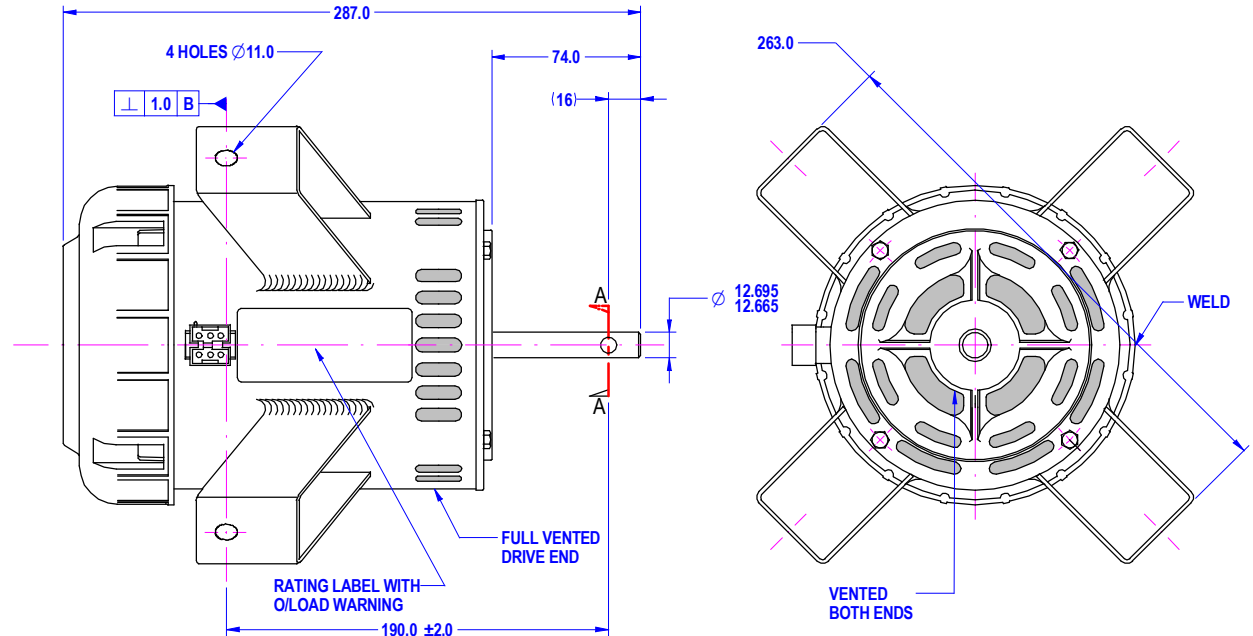

RELATIVE POSITION OF POLARIZING TAB & COWL MUST BE MAINTAINED

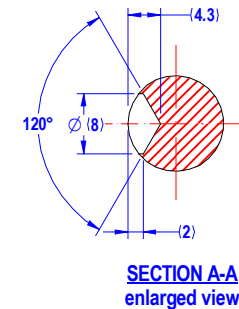

DESIGNED AND MANUFACTURED TO AUSTRALIAN STANDARDS & SPECIFICATIONS

N693

MODEL	6011637S	ddmmyyxxxx
MODEL	80855BQVA-A17S	

VOLTS	240	R.P.M.	1350	CLASS	F155	Hz	50
WATTS	750	TYPE	CSR	μF/V S	NIL	Ph	1
AMPS	4.9	DUTY	S1 AOM	μF/V R	20/440	PROT.	AUTO

WARNING

MOTOR FITTED WITH INTERNAL AUTO RESET OVERLOAD AND MAY RESTART WITHOUT WARNING

SPECIAL REQUIREMENTS:

- 1) RATING LABEL 393-557-07 DOES NOT SHOW DATA AS ON SP85178-02 (IT IS CUSTOMER SUPPLIED INFORMATION.)
- 2) MOTORS TO BE PACKED IN INDIVIDUAL CARTONS WITH RATING LABEL PUT ON BOTH CARTON AND MOTOR.

UNLESS OTHERWISE SPECIFIED : DIMENSIONS ARE IN MM. TOLERANCES

DECIMALS	ANGULAR
.X ± 1.0	± 30'
.XX ± 0.5	

THIS DRAWING REMAINS THE PROPERTY OF FASCO MOTORS AND MAY NOT BE USED, COPIED OR ISSUED WITHOUT WRITTEN PERMISSION FROM FASCO MOTORS

MOTOR WEIGHT	X.X kg.	
DRAWN	SYDNEY	24/11/98
CHECKED	PIPAT	26/10/01
RELEASED	PIPAT	26/10/01
SCALE	N.T.S.	



29/7-8 MOO 3, BANGKRUAY - SAINOI Rd., BANGKRANG, MIANG NONTABURI DISTRICT, NONTABURI 11000 THAILAND

FRAME	MOTOR	
STATUS	R	
SHEET	178:855BV-750-HAD:ILEC	
A3	DWG. NO.	80855BQVA-A17S
	REVISION	D